

kassow robots
strong · fast · simple

Joining forces with

rexroth
A Bosch Company

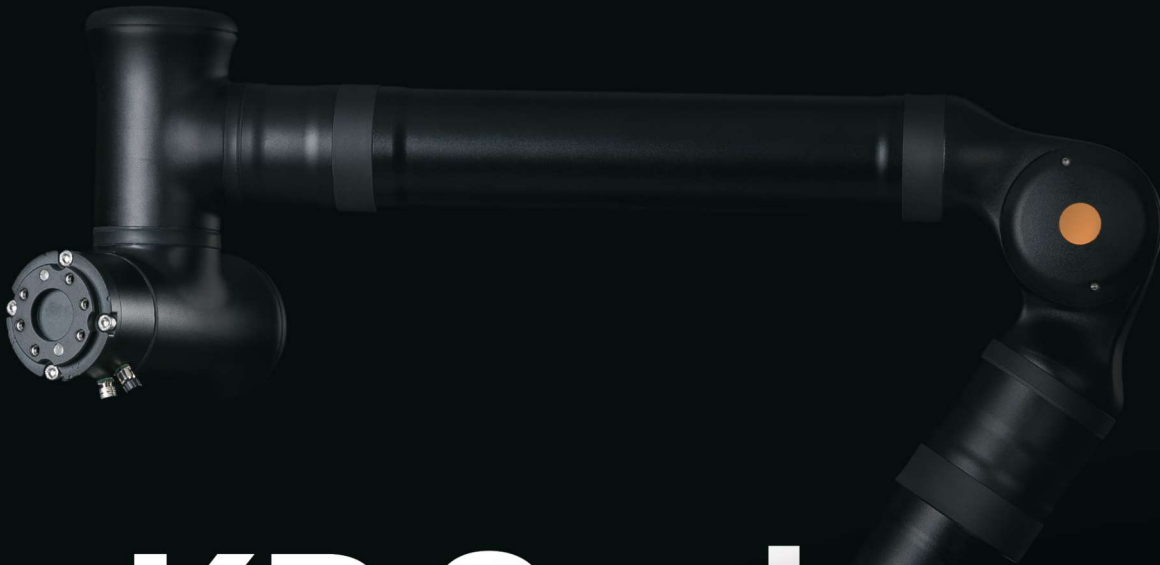

KR Series

Strong, fast, simple. Meet the 7-axes industrial cobot.



Payload
up to **18 kg**



Reach
up to **1800 mm**



Speed
up to **225°/s**

Unlock your potential

Automate your operations with Kassow Robots.

Revolutionize your manufacturing process by integrating robotics into your production line. Boost productivity with tireless automation, ensuring precision, consistency, and accelerated workflows.

A unique combination of the 7th axis, payload & reach. From 5 to 18 kg and a reach of 850 to 1800 mm – all delivered at joint speeds of up to 225 degrees per second. Our range of 5 models allows to reach around the corners, and undertake the most demanding manufacturing tasks.



Plug-in configuration



Intuitive user interface, powerful Android System



Easy relocation, lightweight design



Higher production

Our cobot will take over the repetitive and physically demanding tasks in your factory so workers can then perform jobs that generate more value.

Easy-to-integrate solutions for a wide range of applications.

Welding, packaging, palletizing, CNC & machine tending, pick&place, quality inspection, screwing, labelling, dispensing...

Check out our **Use Cases**



Reach every corner with 7 axes.

Every cobot made by Kassow Robots has a 7th axis. This additional axis gives our cobots the highest possible degree of freedom. The user is able to control the position of the elbow, further increasing the safety. The robot's arm mimics the dexterity of the human arm. A feature that enables it to reach around corners.

From standard to sophisticated tasks our cobots are prepared to perform the infinite number of jobs required in factory automation operations.

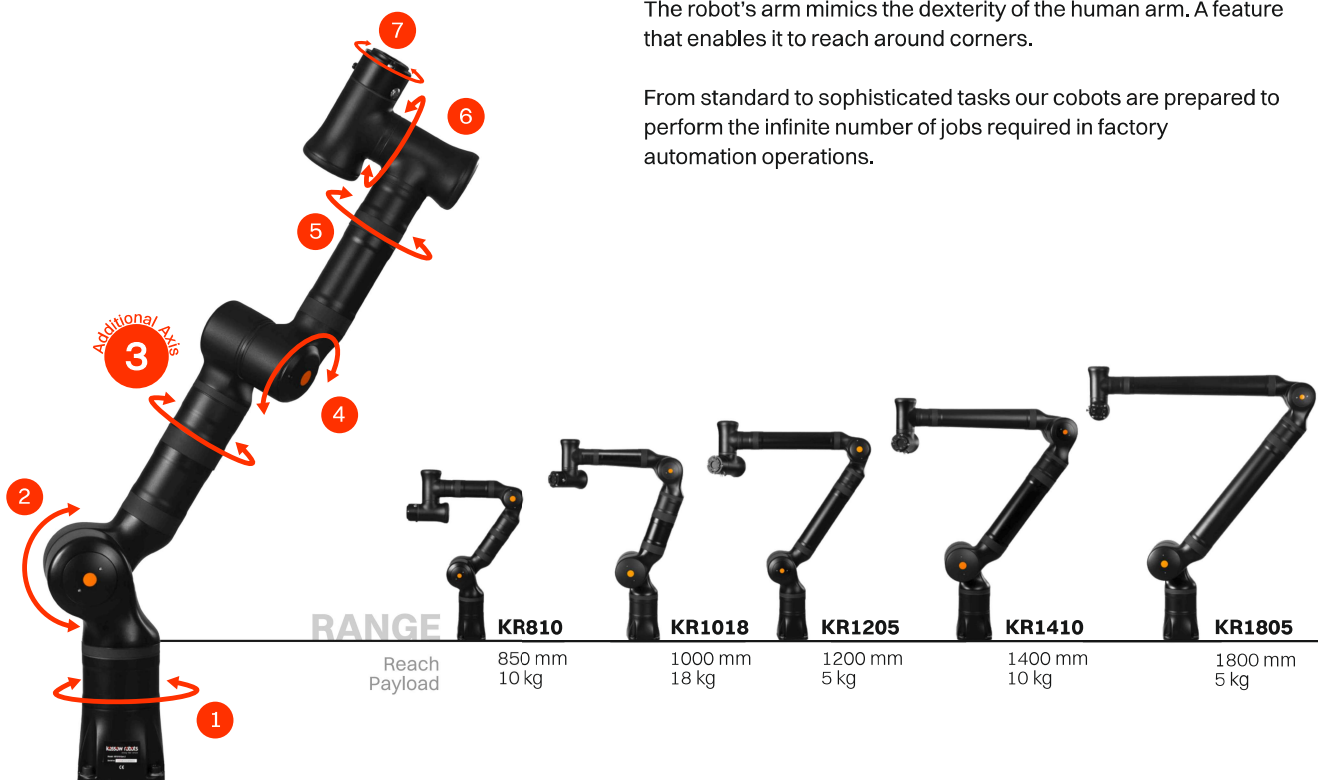



Great maneuverability & around-the-corner reach

You can use the robot's arms in extremely confined spaces – and profit from the tremendous flexibility created by the 7th axis!

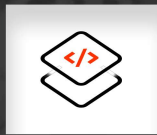

Easy programming & operations

Divorce yourself from robot experts – program and operate the cobots yourself!

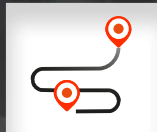

High flexibility & fast relocation

Use the cobots in different places within your production facilities – the cobots' light weight and the plug and play approach makes it possible!

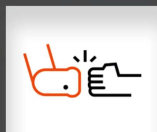

Employees & cobots team up

Delegate the repetitive and unsafe jobs to your robot colleagues – and allow your employees to generate more added value elsewhere!



Fast ROI & more satisfied employees

Our cobots pay for themselves quickly – boost your competitiveness with their high productivity!

Dimensions & special product features.

Solid construction reflected by an all-aluminum surface and very strong materials. Our five models offer an exceptional durability, ensuring optimal performance in any setting. Compatible with a high variety of tools and a small base for an easy deployment in super confined spaces.

DIMENSIONS OF THE BASE PLATE

KR1018, KR1410, KR1805

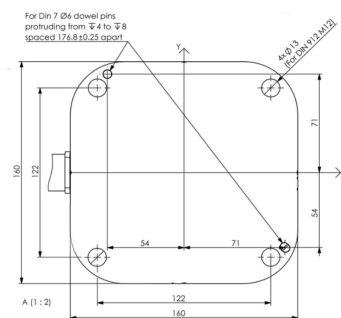

KR810, KR1205

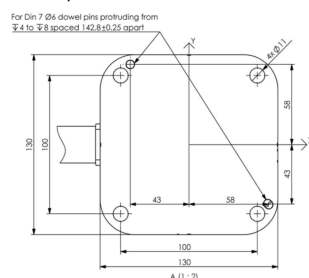

ROBOT HEAD & PORTS

All cobot models

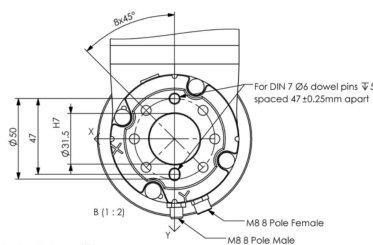

Connectivity

- Two I/O connectors with 24V/3A
- RS485 for connecting an end-of-arm tool
- 8 digital inputs/outputs

Free drive button

- Flexible waypoint programming
- Operation without a user panel

KR Series Technical specifications

| General specifications | KR810 | KR1018 | KR1205 | KR1410 | KR1805 |
|---------------------------------------|---|-----------|-----------|-----------|-----------|
| Reach (mm) | 850 | 1000 | 1200 | 1400 | 1800 |
| Payload (kg) | 10 | 18 | 5 | 10 | 5 |
| Weight (kg) | 26 | 36 | 27 | 37 | 40 |
| Joint speed (deg/s) | 225 | 163/225 | 225 | 163/225 | 163/225 |
| Joint ranges (deg) | J2 and J4: -70°/+180°; J1, J3, J5, J6 and J7: ±360° | | | | |
| Redundant absolute encoders on joints | Yes | Yes | Yes | Yes | Yes |
| Repeatability (mm) | +/- 0.03 | +/- 0.03 | +/- 0.03 | +/- 0.03 | +/- 0.04 |
| Degrees of freedom | 7 | 7 | 7 | 7 | 7 |
| Footprint (mm) | 130 × 130 | 160 × 160 | 130 × 130 | 160 × 160 | 160 × 160 |
| Operating temperature (°C) | 0–45 | 0–45 | 0–45 | 0–45 | 0–45 |
| Body material | Aluminium | | | | |
| Protection rating | IP54 | IP54 | IP54 | IP54 | IP54 |
| Sound level (dB) | <65 | <65 | <65 | <65 | <65 |
| Communication | Modbus (Master), Profinet (IO Device), ROS1/ROS2, KORD, TCP/IP, UDP | | | | |

| Controller | KR810 | KR1018 | KR1205 | KR1410 | KR1805 |
|---|-------|--------|--------|--------|--------|
| Digital inputs dedicated E-stop & P-stop (Safety uses 2x I/Os for redundancy) | 4 | 4 | 4 | 4 | 4 |
| External 24V supply (A) | 6 | 6 | 6 | 6 | 6 |
| Relay outputs | 4 | 4 | 4 | 4 | 4 |
| Digital outputs (Safety supported in pairs) | 8 | 8 | 8 | 8 | 8 |
| Digital inputs (Safety supported in pairs) | 16 | 16 | 16 | 16 | 16 |
| Analogue I/O 0–10V | 2/2 | 2/2 | 2/2 | 2/2 | 2/2 |
| Analogue I/O 4–20mA | 2/2 | 2/2 | 2/2 | 2/2 | 2/2 |

| Power | KR810 | KR1018 | KR1205 | KR1410 | KR1805 |
|---------------------------------------|--------------------|--------------------|--------------------|--------------------|--------------------|
| Power consumption (with max. load; W) | 400–600 | 400–1200 | 400–600 | 400–1200 | 400–1200 |
| Supply voltage (VAC) | 100–120 or 200–240 | 100–120 or 200–240 | 100–120 or 200–240 | 100–120 or 200–240 | 100–120 or 200–240 |
| Supply current (A) | 16 | 16 | 16 | 16 | 16 |
| Supply frequency (Hz) | 50/60 | 50/60 | 50/60 | 50/60 | 50/60 |



Kassow Robots Aps
 Kajakvej 2,
 2770 Kastrup/Copenhagen,
 DENMARK
 +45 20 24 09 95
sales@kassowrobots.com
kassowrobots.com

kassow robots
 strong · fast · simple

Joining forces with

